

## 21 Lorne Avenue, Killara

### CURRENT STATUS:

This Planning Proposal was Finalised on 04/08/2017.

### DETAILS:

Planning proposal to rezone existing site from R2 Low Density to R4 Residential High density under the KLEP 2015.

View Current Planning Proposal [HERE](#)

### MAP:

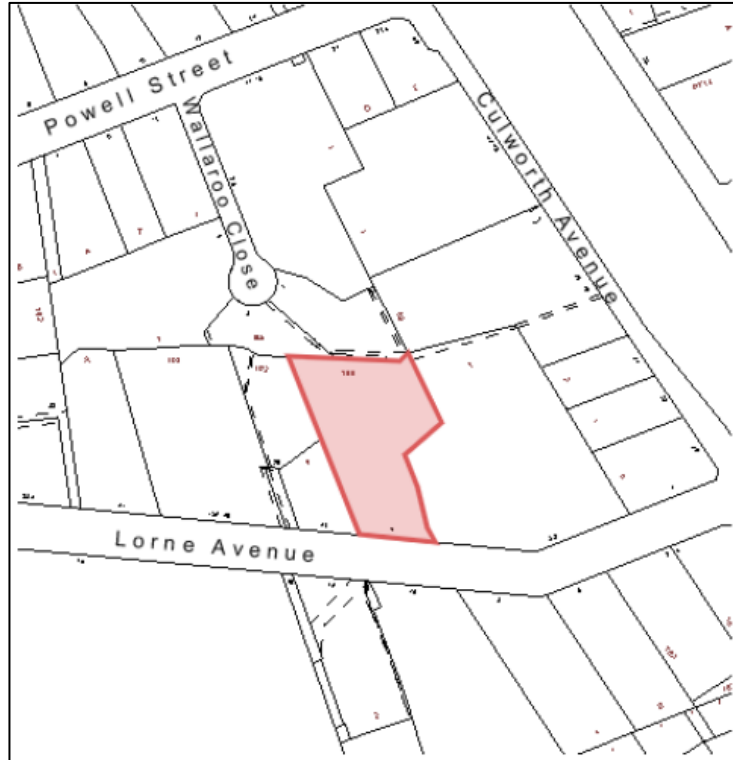

### STATUS:

Description	Date
<a href="#">Report to Council</a> and <a href="#">Council Resolution</a>	07/02/2017
Submitted to Department for Gateway Determination	07/02/2017
<a href="#">Gateway Determination Issued</a>	20/03/2017
Public Exhibition	06/04/2017 – 05/05/2017
<a href="#">Report to Council</a> and <a href="#">Council Resolution</a>	27/06/2017
Gazettal	04/08/2017
<b>This Planning Proposal was Finalised on 04/08/2017.</b>	